

AIRCUB — FRESH TECHNICAL DATA SHEET

Device for perfuming air inside closed compartments or restricted spaces.

INSTALLATION DIAGRAM FOR AIRCUB LIGHT

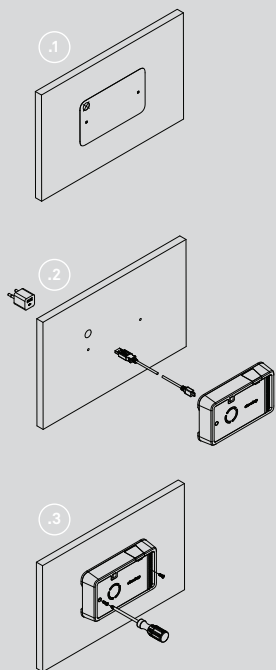

TECHNICAL SPECIFICATIONS:

- Use the template to mark the drilling position for wiring and securing the device (.1)
- Make a hole for the cable passage and the pre-drilled holes for securing the device (.2)
- Connect the micro USB socket to the object, pass the cable through the appropriate hole and put the object into position
- Secure AirCub Light with self-tapping screws (.3), then connect the socket to the power supply.

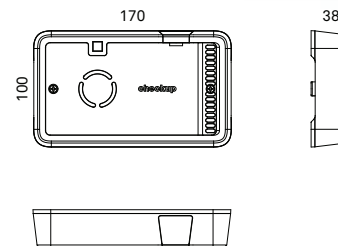

COD. AIFREPNP

- ABS body W. 170 mm H. 100 mm D. 38 mm
- 1 fan with a capacity of 3.2 m3/h
- Interchangeable scented ceramic filter
- Power supply 100-240 V 50-60 Hz

COD. AIFREPNP/PB

- Available in a version powered by a power bank



SCENTED FILTER

- Interchangeable scented ceramic filter
- Available No. 6 scented natural essences that can be purchased on Amazon: Cream, Lemon Balm, Softwood, Greenberry, Linen, Baby Powder