

Eclipse SELF montagehandleiding

Technische Fiche



DU PONT
HANDEL EN MAATWERK



Alban Giacomo spa

COMPANY WITH
QUALITY SYSTEM
CERTIFIED BY DNV
ISO 9001

ISTRUZIONI DI MONTAGGIO / ASSEMBLY INSTRUCTIONS

ECLIPSE 3.2 HD SELF ECLIPSE 3.4 HD SELF

- ① Inserire la cerniera nel telaio
Insert the hinge into the frame

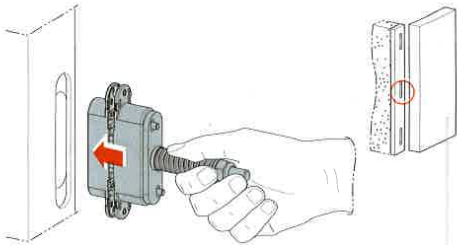

- ② Aprire la cerniera di 90°
Open the hinge at 90°

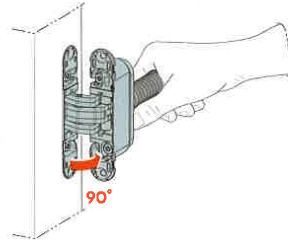

- ③ Inserire il fermo tra le leve, al centro della cerniera
Insert the stopper between the levers, in the middle of the hinge

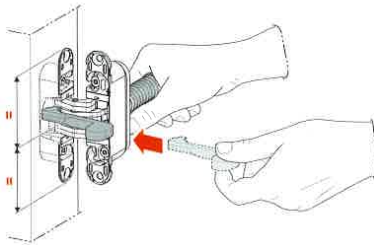

- ④ Fissare la cerniera al telaio
Fasten the hinge to the frame

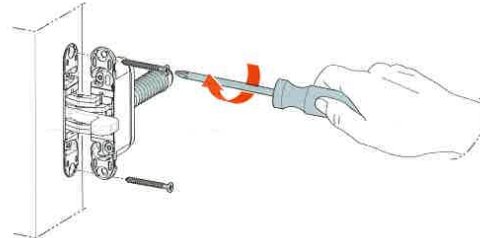

- ⑤ Regolare la forza della cerniera
Adjust the hinge closing force

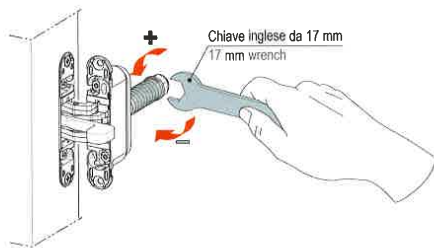

- ⑥ Fissare la cerniera all'anta
Fasten the hinge to the sash

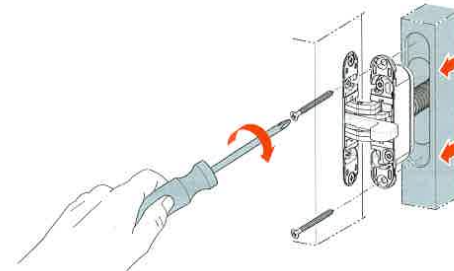

- ⑦ Togliere il fermo
Remove the stopper

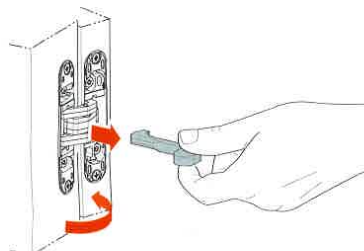

Eclipse SELF montagehandleiding

Technische Fiche



DU PONT
HANDEL EN MAATWERK

Istruzioni di montaggio / Assembly instructions

8 Regolazioni Adjustments

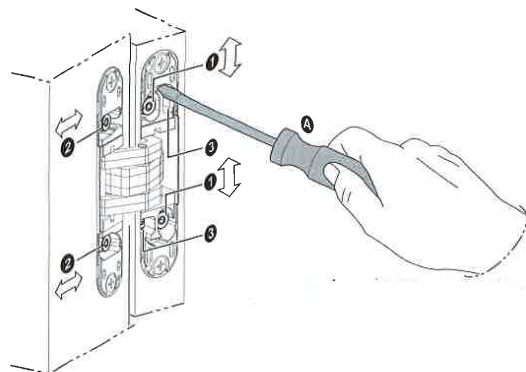

Effettuare le seguenti regolazioni una per volta con chiave a brugola da 3 mm:

- Regolazione verticale ± 2 mm: per ottenere la regolazione desiderata allentare le viti ❶ e, contrastando la spinta della molla, spostare verticalmente il corpo cerniera aiutandosi con un cacciavite a taglio (A) e utilizzando il cuneo art. E30200.89.01.

Ad operazione terminata fissare le viti.

- Regolazione in pressione ± 1 mm: allentare le viti ❷ e spostare il corpo cerniera. Ad operazione terminata fissare le viti.

- Regolazione orizzontale $\pm 1,5$ mm: agire sulle viti ❸.

Please adjust the hinges one by one, using a 3 mm Allen key:

- ± 2 mm vertical adjustment: to reach the desired adjustment, loosen the screws ❶ and, against the spring thrust, move vertically the hinge body by using a screwdriver (A) and the wedge, art. E30200.89.01.

After this operation, fasten the screws.

- ± 1 mm pressure adjustment: loosen the screws ❷ and move the hinge body. After this operation, fasten the screws.

- $\pm 1,5$ mm horizontal adjustment: move the screws ❸.

9 Applicare le coperture Apply the covers

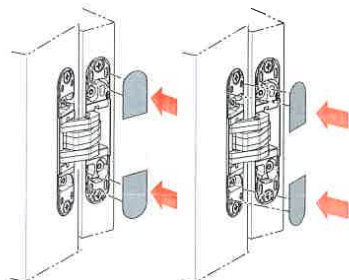

INFORMAZIONI TECNICHE / TECHNICAL INFORMATION				
		ADATTA PER ANTE SUITABLE FOR SASHES	COMPATIBILITA' COMPATIBILITY	SERRATURA LOCK
Eclipse 3.2 HD SELF	BLU / BLUE	Fino a / Up to 40 Kg	Eclipse 3.0 Eclipse 3.2 Eclipse 3.2 HD	Consigliato l'utilizzo con serrature magnetiche. The use with magnetic locks is suggested.
	ROSSA / RED	Fino a / Up to 60 Kg		
Eclipse 3.4 HD SELF	ROSSA / RED	Fino a / Up to 60 Kg	Eclipse 3.4 Eclipse 3.4 HD	



Queste cerniere sono state progettate per funzionare in modo ottimale tra gli 0° e 170° di apertura della porta.
These hinges have been designed to work properly between 0° and 170° of door opening.

Z90161.11.88 - (V5) - 02.22 - Communications Dept. - Printed in Italy